

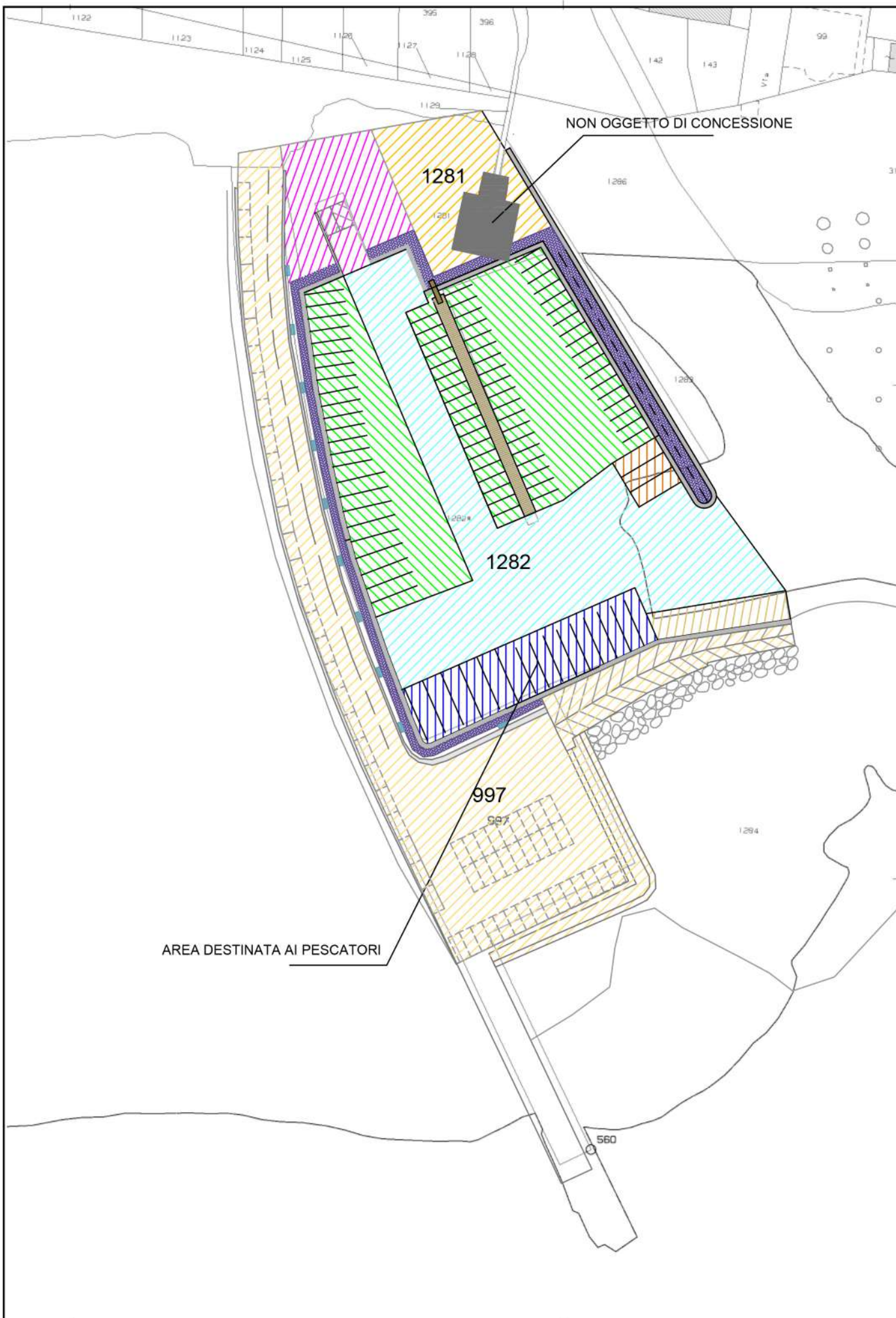











TAVOLA 1 - ORTOFOTO OGGETTO DI CONCESSIONE



### LEGENDA

-  Specchio acqueo libero : 2188,03 mq
-  Area destinata ad alaggio e varo : 570,71mq
-  Area traffico limitato destinato alle attività portuali :551,75 mq
-  Aree complementari destinate a viabilità e parcheggi : 3343,95 mq
-  Aree destinate all'ormeggio delle imbarcazioni da diporto : 2535,69 mq
-  Area dello specchio acqueo riservato all'ormeggio dei pescherecci: 615,64 mq
-  Area dello specchio acqueo riservata alle Autorità Marittime : 104,16 mq
-  Aree dello specchio acqueo riservata ai mezzi di soccorso: 159,07 mq
-  Aree molo galleggiante: 123,4 mq